

resideo



Braukmann

DS06 DialSet®

LEAD FREE PRESSURE REGULATING VALVES

SUBMITTAL SHEET

Job Name	
Engineer	
Mechanical Contractor	
Contractor's P.O. No.	
Representative	
Notes	

Model(s)				
	Qty.		Notes	
	Qty.		Notes	
	Qty.		Notes	
Approval Service				
Tag No.				

APPLICATION

The Resideo DS06 DialSet Pressure Regulating Valve is a high-quality pressure regulating valve that maintains a constant outlet pressure over a wide range of inlet supply pressures. It is suitable for potable water and irrigation applications. The downstream pressure adjustment dial eliminates the need for a pressure gauge when adjusting the pressure setting (static pressure only).

SPECIFICATIONS

- Model:** DS06 DialSet Pressure Regulating Valves
- Regulator Mechanism:** Fabric-reinforced diaphragm.
- Seat Design:** Balanced single seat construction.
- Inlet Pressure (Maximum):** 250 psi maximum.
- Reduced Pressure Range:** 25 to 90 psi (1/2 in. to 2 in.).
- Outlet Pressure:** Factory set at 60 psi (414 kPa).
- Dial Calibration:** ± 4 psi.
- Differential:** 14.5 psi minimum (inlet to outlet).
- Fluid Temperature (Maximum):**
Water: 140° F (60° C).
- Ambient Temperature Range:** 33° F to 140° F (1° C to 60° C).
- Pipe Sizes Available:**
1/2 in., 3/4 in., 1 in., 1-1/4 in., 1-1/2 in. and 2 in. available.
- Connections:** Can be configured as female thread-by-thread, single - or double-union, NPT threaded, sweat, or press.
- Low Lead Content:** < 0.08% lead.
- Gauge Tap:** 1/4" NPT.
- Approvals:**
ASSE 1003-2020 Listed
CSA B356 Listed
IAPMO/UPC Listed
NSF/ANSI 61/372 Compliant
- Thermal Expansion:** Balanced cartridge design allows for thermal expansion properties. Use expansion tanks and safety valves where applicable.

MATERIALS

- Body:** Lead-free ECO BRASS®
- Internal Parts:** Stainless steel and engineered plastics
- Regulator Mechanism:** Fabric-reinforced diaphragm
- *Lead Free Plumbing Code Compliance:** The wettable surfaces of lead-free models contain less than 0.25% of lead by weighted average.

DIMENSIONS

Model Number	Pipe Size	Dimensions, Approximate	
	Inch	Inch (H x L)	mm (H x L)
Single-Union Sweat			
DS06-100-SUS-LF	1/2"	5-53/64" x 3-55/64"	148 x 98
DS06-101-SUS-LF	3/4"	5-53/64" x 4-3/8"	148 x 111
DS06-102-SUS-LF	1"	6-15/16" x 5-15/64"	176.5 x 133
DS06-103-SUS-LF	1-1/4"	6-15/16" x 5-5/8"	176.5 x 143
DS06-104-SUS-LF	1-1/2"	11-13/16" x 6-39/64"	300 x 168
DS06-105-SUS-LF	2"	11-13/16" x 7-13/32"	300 x 188
Single-Union Threaded			
DS06-100-SUT-LF	1/2"	5-53/64" x 4-1/64"	148 x 102
DS06-101-SUT-LF	3/4"	5-53/64" x 4-3/8"	148 x 111
DS06-102-SUT-LF	1"	6-15/16" x 5"	176.5 x 127
DS06-103-SUT-LF	1-1/4"	6-15/16" x 5-7/16"	176.5 x 138
DS06-104-SUT-LF	1-1/2"	11-13/16" x 6-1/2"	300 x 165
DS06-105-SUT-LF	2"	11-13/16" x 6-31/32"	300 x 177
Single-Union Press			
DS06-100-SUP-LF	1/2"	5-53/64" x 4-13/32"	148 x 112
DS06-101-SUP-LF	3/4"	5-53/64" x 4-63/64"	148 x 126.5
DS06-102-SUP-LF	1"	6-15/16" x 5-3/8"	176.5 x 136
DS06-103-SUP-LF	1 1/4"	6-15/16" x 5-22/32"	176.5 x 145
DS06-104-SUP-LF	1 1/2"	11-13/16" x 6-31/32"	300 x 177
DS06-105-SUP-LF	2"	11-13/16" x 7-33/64"	300 x 191
Union Body, No Tailpieces Only			
DS06-100-LF	1/2"	5-53/64" x 3-5/32"	148 x 80
DS06-101-LF	3/4"	5-53/64" x 3-35/64"	148 x 90
DS06-102-LF	1"	6-15/16" x 3-15/16"	176.5 x 100
DS06-103-LF	1-1/4"	6-15/16" x 4-9/64"	176.5 x 105
DS06-104-LF	1-1/2"	11-13/16" x 5-1/8"	300 x 130
DS06-105-LF	2"	11-13/16" x 5-33/64"	300 x 140
Double-Union Sweat			
DS06-100-DUS-LF	1/2"	5-53/64" x 4-9/16"	148 x 116
DS06-101-DUS-LF	3/4"	5-53/64" x 5-13/64"	148 x 132
DS06-102-DUS-LF	1"	6-15/16" x 6-17/32"	176.5 x 166
DS06-103-DUS-LF	1-1/4"	6-15/16" x 7-1/8"	176.5 x 181
DS06-104-DUS-LF	1-1/2"	11-13/16" x 8-7/64"	300 x 206
DS06-105-DUS-LF	2"	11-13/16" x 9-19/64"	300 x 236
Double-Union Threaded			
DS06-100-DUT-LF	1/2"	5-53/64" x 4-7/8"	148 x 124
DS06-101-DUT-LF	3/4"	5-53/64" x 5-13/64"	148 x 132
DS06-102-DUT-LF	1"	6-15/16" x 6-1/16"	176.5 x 154
DS06-103-DUT-LF	1-1/4"	6-15/16" x 6-47/64"	176.5 x 171
DS06-104-DUT-LF	1-1/2"	11-13/16" x 7-7/8"	300 x 200
DS06-105-DUT-LF	2"	11-13/16" x 8-27/64"	300 x 214
Double-Union Press			
DS06-100-DUP-LF	1/2"	5-53/64" x 5-43/64"	148 x 144
DS06-101-DUP-LF	3/4"	5-53/64" x 6-27/64"	148 x 163
DS06-102-DUP-LF	1"	6-15/16" x 6-49/64"	176.5 x 172
DS06-103-DUP-LF	1 1/4"	6-15/16" x 7-9/32"	176.5 x 185
DS06-104-DUP-LF	1 1/2"	11-13/16" x 8-13/16"	300 x 224
DS06-105-DUP-LF	2"	11-13/16" x 9-17/32"	300 x 242



33-00063-11

WATER CAPACITIES

The suitability of a given regulator size is dependent on the pressure requirements where it will operate. For the pressure regulator valve size required for a specific installation, determine the following:

1. Pressure differential between inlet and outlet pressure in pounds per square inch (psi),
2. Capacity in gallons per minute, and
3. Allowable reduced pressure falloff in psi. Given these variables, use the table below to determine the proper size pressure regulator valve for your application.

Example: An installation has 135 psi inlet pressure, 60 psi outlet pressure (75 psi pressure differential). If a 15 gpm capacity is required with only 10 psi falloff allowable, a 3/4 in. DS06 is required.

Pressure Regulator Valve Size	Reduced Pressure Falloff (PSI)	Pressure Differential Between Inlet and Outlet.			
		25 psi	50 psi	75 psi	100 psi or more
		Flow Capacity (US gpm)	Flow Capacity (US gpm)	Flow Capacity (US gpm)	Flow Capacity (US gpm)
1/2"	6	7.26	8.15	7.44	6.47
	10	10.7	10.66	9.69	8.85
	15	14.27	15.72	14.49	13.96
	20	17.74	19.59	18.98	18.1
3/4"	6	11.98	14.44	14.53	14.97
	10	17.17	21.05	25.23	26.33
	15	19.86	25.14	29.32	32.85
	20	21.27	26.42	30.42	33.82
1"	6	11.18	11.23	9.51	9.11
	10	18.01	18.98	17.39	16.78
	15	25.67	28.14	28.71	26.9
	20	30.69	34.7	36.19	35.05
1-1/4"	6	7.53	6.34	7.26	7.13
	10	20.25	17.88	15.15	14
	15	33.02	34.87	32.63	29.68
	20	40.07	44.29	46.01	34.61
1-1/2"	6	29.81	32.27	30.87	26.81
	10	46.14	50.02	49.89	47.82
	15	66.22	78.42	86.74	84.14
	20	77.14	92.29	103.82	109.68
2"	6	27.34	25.8	24.48	18.01
	10	64.81	97.61	78.15	90.09
	15	82.82	105.14	119.94	129.62
	20	87.66	107.83	120.95	132.09

DS06 FIXTURE UNIT

Flow rates based on submittal sheet DS06, based on flush tank systems with a 15 psi fall-off defined by IAPMO/ANSI UPC 1-2009.

Size	l/s	GPM	Fixture Units
1/2"	0.99	15.72	21
3/4"	1.58	25.14	40
1"	1.77	28.14	48
1-1/4"	2.19	34.87	70
1-1/2"	4.93	78.42	270
2"	6.61	105.14	400

Capacities are based on a 100 psi supply pressure and a difference of 50 psi or more between the initial supply pressure and the reduced no-flow pressure. Check local water pressures before selection.

EXPLODED VIEW

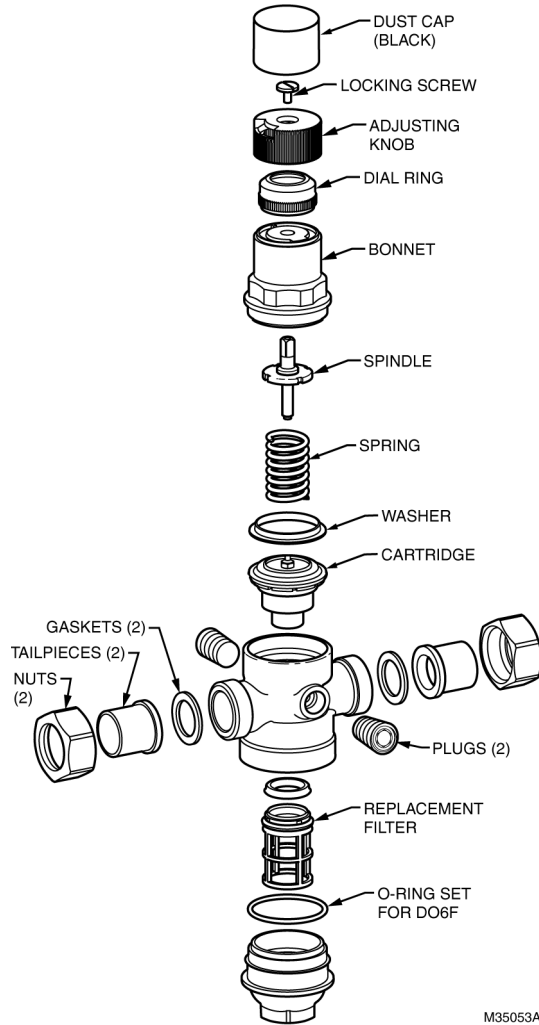

M35053A

By using this Resideo literature, you agree that Resideo will have no liability for any damages arising out of your use or modification to the literature. You will defend and indemnify Resideo, its affiliates and subsidiaries, from and against any liability, cost, or damages, including attorneys' fees, arising out of, or resulting from, any modification to the literature by you.



Resideo Technologies, Inc.
1985 Douglas Drive North, Golden Valley, MN 55422
1-800-468-1502
33-00063-11 SA Rev.12-23