

resideo

Wiring Configuration



INSTALLATION ADDENDUM

ADVANCED MODELS (HE150/HE250/HE300)

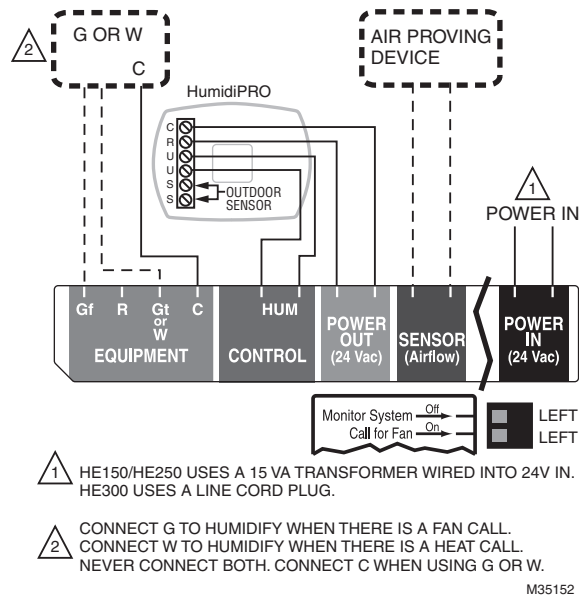

Fig. 1. Wiring HumidiPRO (H6062) to humidify only with a call for Heat or Fan.

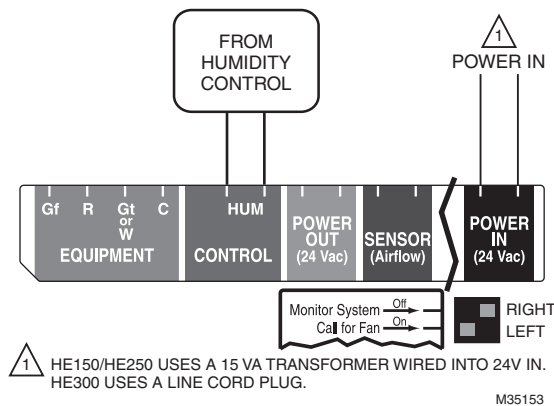

Fig. 2. Wiring TrueIAQ, VisionPRO IAQ, or Prestige, using the intelligent control to program humidity calls with heat, cool, or on demand.



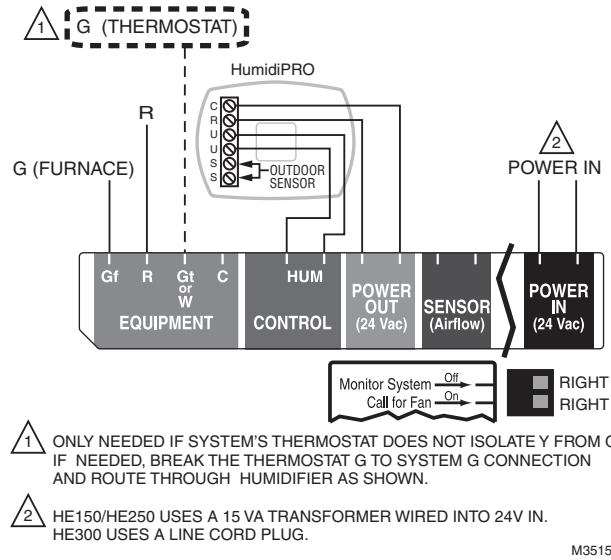

Fig. 3. Wiring to force the HVAC system fan on whenever humidity is needed (on demand).

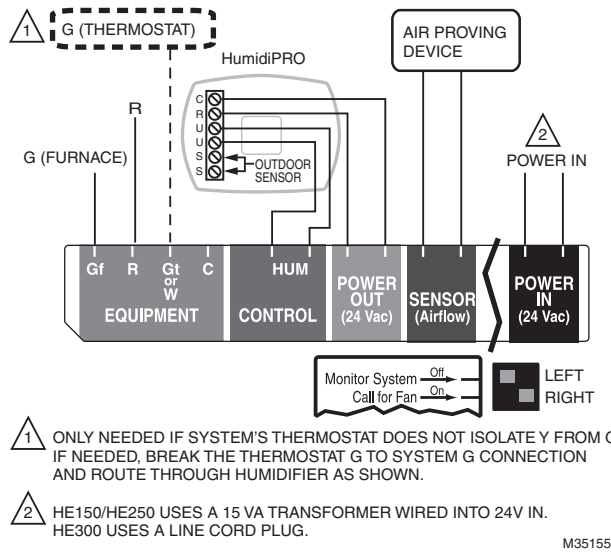

Fig. 4. Wiring to force fan on and prove airflow in the duct.

BASIC MODELS (HE100/HE200)

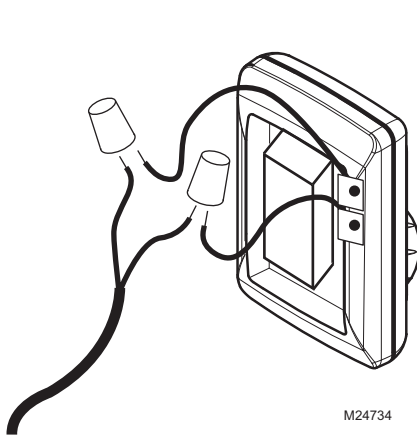

Fig. 5. Wiring connections on the H8908 humidistat.

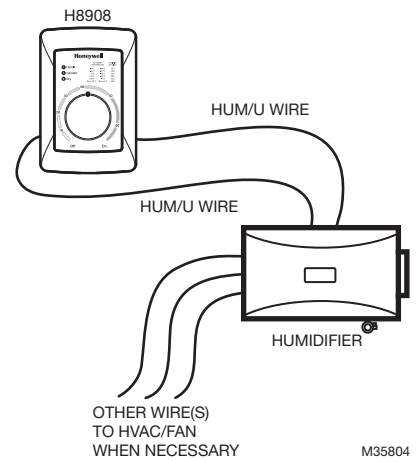

Fig. 6. Wiring H8908 humidistat.

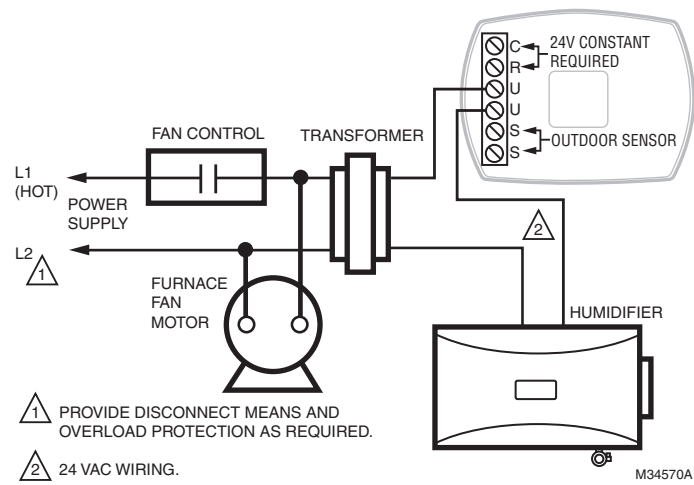

Fig. 7. Wiring HumidiPRO with fan interlock.

WIRING CONFIGURATION

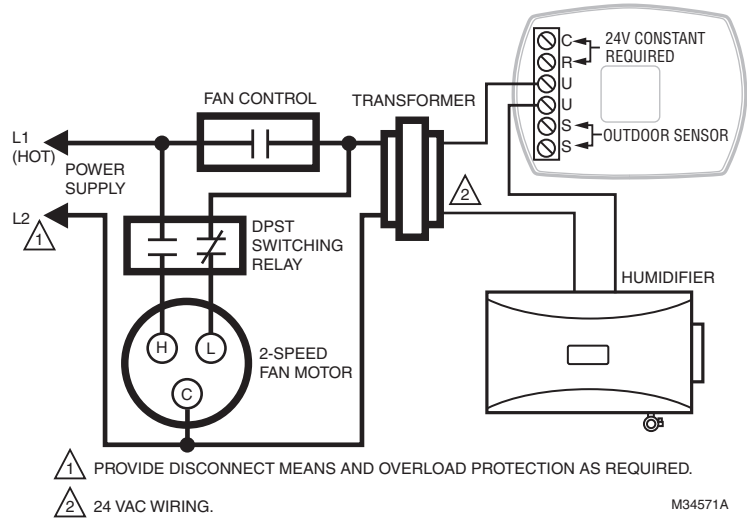

Fig. 8. Wiring HumidiPRO with 2-speed fan motor.

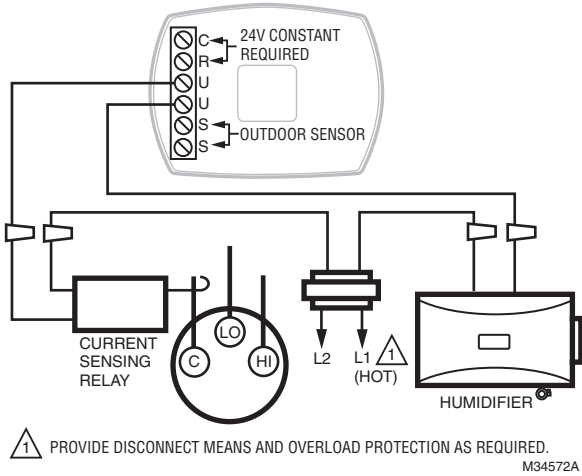

Fig. 9. Wiring HumidiPRO with current sensing relay.

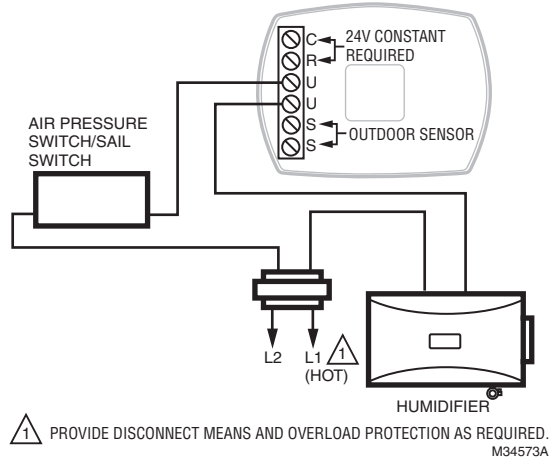

Fig. 10. Wiring HumidiPRO with air proving device.



Resideo Technologies, Inc.
 1985 Douglas Drive North, Golden Valley, MN 55422
 1-800-468-1502
 69-2576-06 M.S. Rev. 03-21 | Printed in United States

www.resideo.com

© 2020 Resideo Technologies, Inc. All rights reserved.
 This product is manufactured by Resideo Technologies, Inc. and its affiliates.