



Submittal Data/
Instruction Sheet
SD/IS 200

Effective
September 1, 1998
Supersedes
November 1, 1997

SPARCO POWERVENT 2" - 8" PIPE SIZE

The Sparco Powervent Automatically Eliminates All Trapped Air and Micro-Bubbles from Heating and Cooling Systems.

FEATURES:

- Guarantees fast start up with automatic venting.
- Eliminates "No Heat" call backs.
- Micro-bubble concentrator has three times the impact area of other products.
- Helps prevent corrosion of system components.

SPECIFICATIONS:

- Welded steel construction.
- Stainless steel concentrator wires.
- Available in blow down version, either threaded (T) or flanged (F) and in cleanable version, flanged (FC).
- 3/4" bottom nipple, 1/2 " top nipple.
- 1 to 3 Supervents, removable, with vent check.
- Flow bi-directional.
- Maximum working pressure 150 PSI, max. temperature 250°F.
- Cap for system shut-off. System can be air tested.
- Made in U.S.A., U.S. Patent No. 5,490,874.
- 3 year warranty.
- ASME Certification available at extra cost. Please circle one: YES / NO

SUBMITTAL DATA APPROVAL	
For: _____	
Job: _____	
Date submitted: _____	by: _____
Date approved: _____	by: _____
Model number: _____	quantity: _____
Model number: _____	quantity: _____
Model number: _____	quantity: _____

INSTALLATION:

- Locate where you would normally locate air control.
- Must be installed vertically in horizontal line.
- Straight pipe runs up or downstream not required.
- Install one Supervent on top of sizes 2", 2 1/2", 3" and 4" two on top of sizes 5" and 6" or three on top of 8" size. Supervents are shipped separately.
- Be sure to install vent check provided as part of Supervent between Powervent body and Supervent.
- Install 1/2" ball valve for fast initial venting on top and a 3/4" ball valve for draining at bottom (ball valves not supplied by Sparco).
- During normal operation back off vent cap one turn.
- Tighten vent cap only when air testing system for leaks.

SERVICE:

CONCENTRATOR:

If debris is in the piping system, then the Powervent needs to be cleaned. Proceed as follows:

Blow Down Version: • Open 3/4" ball valve at bottom of Powervent.
(Model T or F)

Cleanable Version: • Close shutoff valves on each side of Powervent.
(Model FC) • Relieve pressure through 3/4" valve at bottom of Powervent.
• Remove blind flange.
• Remove and clean concentrator (2" and 2 1/2") or concentrator assembly (3" and up).

Note: Concentrator may drop out under its own weight when removing blind flange. Replace concentrator and blind flange using a new gasket where necessary.

SUPERVENT: • Remove Supervents by unscrewing threaded connection on top of vent check. **With vent check installed, pressure relieving or draining not necessary.**
• Replace with a new Supervent.

Note: Disassembly and cleaning of old Supervents are possible. Carefully unscrew top and clean float. Flush inside of vent. When reassembling, make sure float chain is free.

MODEL	CONNECTIONS	WGT	A	B	C	CV
PV200T	2" NPT	22.0	11.05	6.18	10.13	95
PV250T	2 1/2" NPT	23.0	11.05	6.18	10.13	140
PV300T	3" NPT	50.0	15.63	7.95	15.50	215
PV400T	4" NPT	52.5	15.63	7.95	15.50	360
PV200F	2" FLANGE	31.5	11.05	6.18	10.25	95
PV250F	2 1/2" FLANGE	37.0	11.05	6.18	10.25	140
PV300F	3" FLANGE	66.0	15.63	7.95	16.00	215
PV400F	4" FLANGE	78.5	15.63	7.95	16.00	360
PV500F	5" FLANGE	147.0	21.00	11.10	24.00	590
PV600F	6" FLANGE	158.0	21.00	11.10	24.00	860
PV800F	8" FLANGE	254.0	25.83	12.92	30.00	1500
PV200FC	2" FLANGE	64.0	11.05	5.85	12.25	95
PV250FC	2 1/2" FLANGE	70.0	11.05	5.85	12.50	140
PV300FC	3" FLANGE	137.0	15.63	7.37	16.00	215
PV400FC	4" FLANGE	150.0	15.63	7.37	17.63	360
PV500FC	5" FLANGE	310.0	21.00	9.85	24.00	590
PV600FC	6" FLANGE	320.0	21.00	9.85	24.00	860
PV800FC	8" FLANGE	516.0	25.83	11.88	30.00	1500

MODEL T

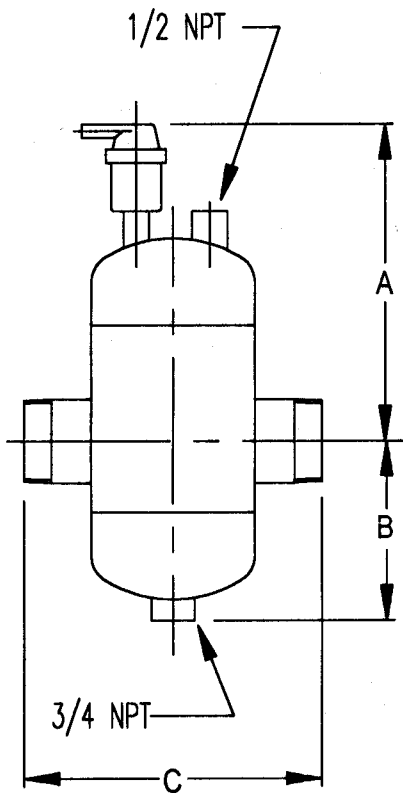

MODEL F

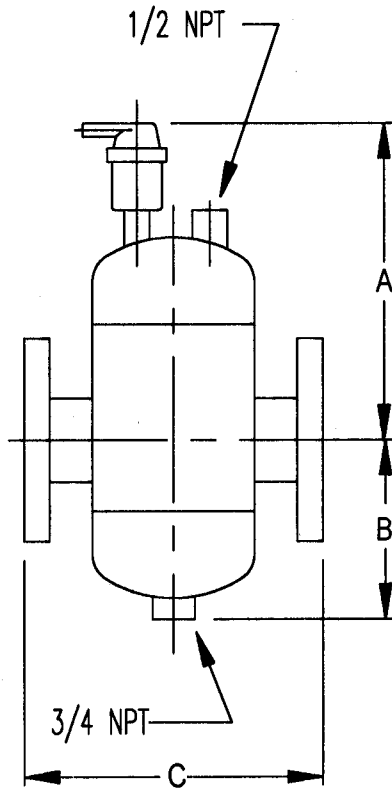

MODEL FC

